



# Product Catalogue

**Finishes Legend** SCP Satin Chrome Plate CP Chrome Plate FB Florentine Bronze Plate PBU Polished Brass Unlaquered BC Black Chrome \* Soft finishes will discolour with age and use All measurements in mm



[www.australianlock.com.au](http://www.australianlock.com.au)



# Contents

## **Galaxy Products**

Introduction	<b>B1</b>
Rim Cylinders	<b>B2</b>
Camlock Cylinders	<b>B3</b>
Deadlocks	<b>B4</b>
Mortice Cylinders	<b>B5 - B6</b>
Euro Din and Oval Cylinders	<b>B7</b>
Padlocks	<b>B8</b>
Supplementary Products	<b>B9</b>
Switchlock Cylinders	<b>B10</b>
Key In Knob/Lever Lockset Cylinders	<b>B11</b>
Galaxy Warranty	<b>B12</b>

# Galaxy Master Key System



Galaxy is the most recent addition to the range of high security master key systems designed, manufactured & distributed by Australian Lock Company.

Using the very latest engineering & manufacturing techniques & using the highest quality materials, Galaxy provides a revolutionary approach to high security locking systems. With subtle technical improvements & considered design, Galaxy offers a host of previously unseen attributes to benefit the end-user & locksmith alike.

Galaxy is designed & built for convenience while maximising security & offering an enormous depth of possible lock combinations.

Its streamlined design eliminates the need for tumbler pins &/or coded discs to create permutations. Galaxy's custom designed & built Computerised

Numerical Control (CNC) machine simultaneously cuts both the key & codebar which dramatically increases production efficiency.

Only authorised Galaxy licensees can design, build & maintain Galaxy restricted master key systems. The Galaxy CNC machine will only operate with the compatible software module authorised by Australian Lock Company. Details of all master key systems designed & built are purged from the CNC machine as soon as keys & codebars are cut. These system details are stored externally providing further security for all parties.

Galaxy's extensive product range makes retrofitting existing locks simple & recombining quick & easy.

Galaxy's stainless steel key comes with a lifetime guarantee against breakage & is available in 22

different key head colours. The key is also available in 3 different orientations making it virtually 3 locks in 1.

The durability of Galaxy is unquestioned with keys & cylinders having been tested to 1,000,000 cycles. Internal components use high quality metal injected moulded manufacturing techniques whilst sidebars & anti-drill components are made from high speed steel.

Galaxy also offers both the end-user & locksmith significant legal protection with Patents valid until 2024.

## Key Colour Range



## Rim Cylinders

### Typical Uses

High Security Door Access  
Meter Boxes  
Commercial Buildings  
Industrial Premises  
Perimeter Door Lock  
Household Front and Rear Doors

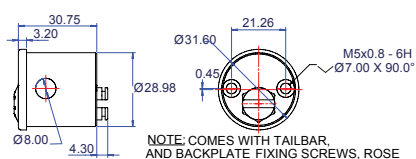

### Rim Cylinder Nightlatch

GXFA2201

Suits: *Boyd, Lockwood, Efco & Whitco*

SCP, CP, PBU, BC, FB

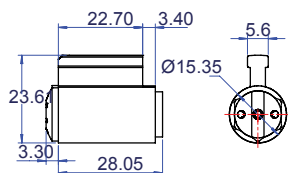

### Lockwood 001 Inner - New Style

GXFA2203

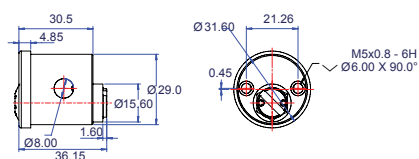

### Lockwood 205/255 Inner

GXFA2205

SCP, PBU

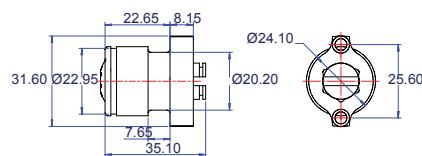

### Abloy Rim Cylinder

GXFA2213

SCP, PBU



### Lockwood 355 Deadbolt

GXFA2235

## Camlock Cylinders

### Typical Uses

Cash Boxes/Registers  
ATMs  
Parking Meters  
Pay Telephones  
Gaming/Vending Machines  
Access/Alarm Control Systems  
Storage Cabinets



180 Degree - Key Retained

CP

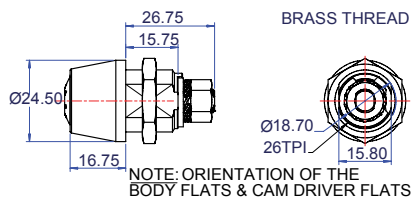

#### 5/8" Thread Length Cam Lock - 16 Code

GXFA32159  
GXFA32151  
GXFA32159D

90 Degrees rotation - key retained  
180 Degrees rotation - key retained  
90 Degrees rotation - key removal 2 Position

CP

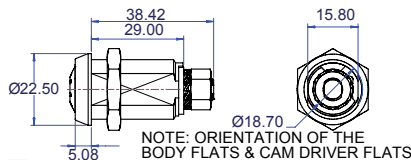

#### 1 1/8" Thread Length Cam Lock - 16 Code

GXFA32199  
GXFA32191  
GXFA32199D

90 Degrees rotation - key retained  
180 Degrees rotation - key retained  
90 Degrees rotation - key removal 2 position

CP

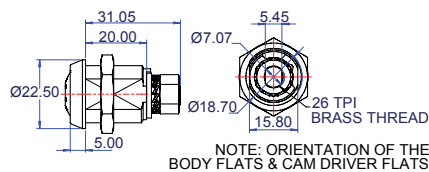

#### 13/16" Thread Length Cam Lock - 10 Code

GXFA32259  
GXFA32251  
GXFA32259D

90 Degrees rotation - key retained  
180 Degrees rotation - key retained  
90 Degrees rotation - key removal 2 position

CP

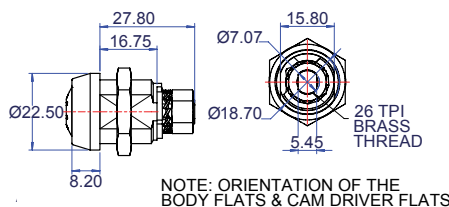

#### 5/8" Thread Length Cam Lock - 10 Code

GXFA32279  
GXFA32271  
GXFA32279D

90 Degrees rotation - key retained  
180 Degrees rotation - key retained  
90 Degrees rotation - key removal 2 position

CP

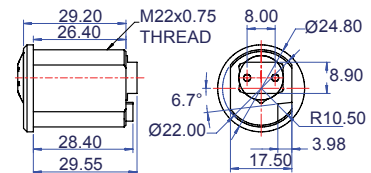

GXFA3223

Suits EWA MB23G

CP

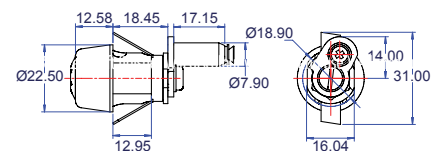

# Galaxy Products

## Deadlocks and Cylinders

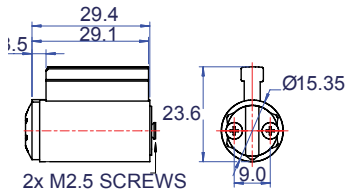
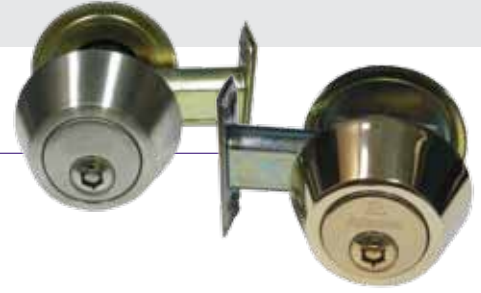

### Lockwood Paradigm

GXFA4205

Also suits Nexion & Onyx

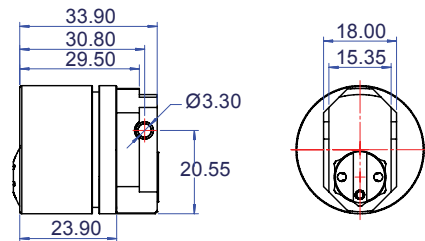

### Lockwood 007/008 Outer

GXFA4207

SCP, PBU

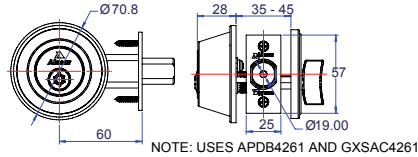

### Cylinder And Turn

GXFA4261

Suits: Lane, Whitco

SCP, PBU, FB

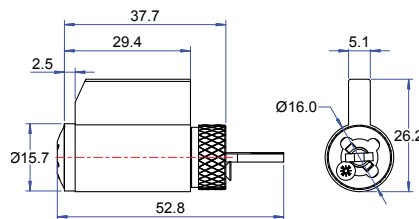

### Cylinder Only

GXFAC4261

Single Cylinder

SCP, PBU

### Filing Cabinet Lock

GXFA3240

180 Degree - Key Retained

CP

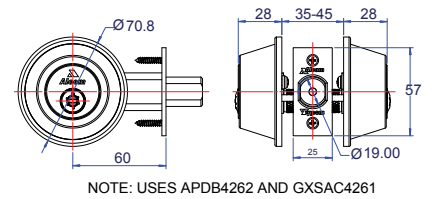

### Double Cylinder

GXFA4262

Suits: Lane, Whitco

SCP, PBU, FB

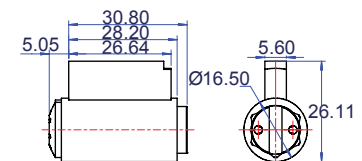

### Lockwood 777 - Old Style

GXFA4277

Cylinder Only

## Mortice Cylinders

### Typical Uses

Commercial Building Entries and Exit Doors  
Internal Security Doors

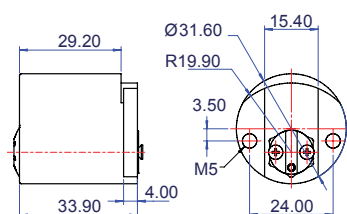

#### Lockwood DKO- Old Style

GXFA5201

Digital Override

SCP, PBU

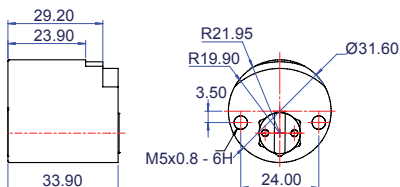

#### Lockwood DKO- New Style

GXFA5202

Digital Override

SCP, PBU

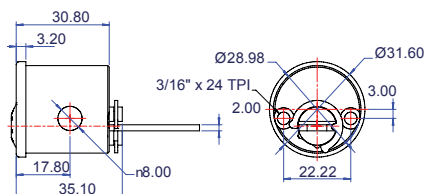

#### EFCO 510

GXFA5210

SCP, PBU

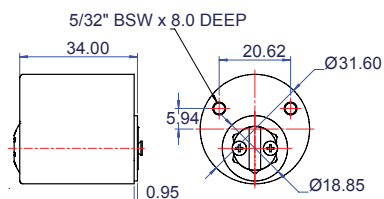

#### Lane Astra Bayonet

GXFA5230

(With Bayonet Fitting)

SCP, PBU

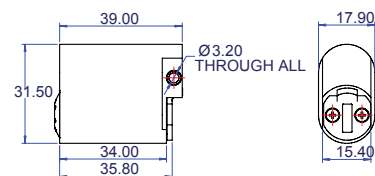

#### Lane Astra (O.C Series)

GXFA5235

SCP, CP, PBU, BC, FB

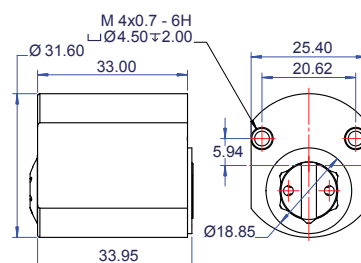

#### Lane Astra Bayonet

GXFA5237

SCP

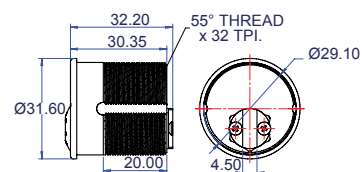

#### Adams Rite/Kawneer

GXFA5260

SCP, CP, PBU, FB

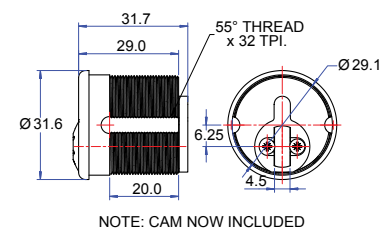

#### Adams Rite/Kawneer, US 1" Thread

GXFA5261

SCP, CP, PBU, FB

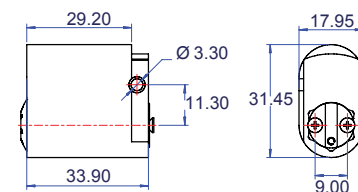

#### Oval Cylinder

Boyd, Gainsborough, Lockwood, Lane, Schlage, suits Alcom 5000 Series Mortice Locks

GXFA5290

SCP, CP, PBU, BC, FB



## Mortice Cylinders *continued*

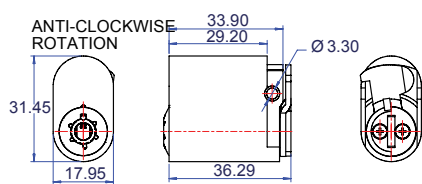

**Mortice Lock  
Holdback, Left Hand Turn**

GXFA5293L

(Complete with Holdback Cam)  
Suits Alcom 5000 Series Mortice Locks

SCP, CP, PBU

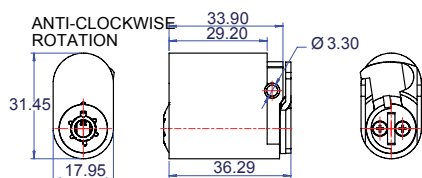

**Mortice Lock  
Holdback, Right Left Hand Turn**

GXFA5293R

(Complete with Holdback Cam)  
Suits Alcom 5000 Series Mortice Locks

SCP, CP, PBU

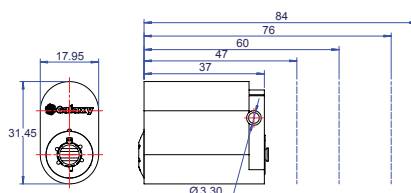

**Extended Oval Cylinder - 37mm**

GXFA529037

**Extended Oval Cylinder - 39mm**

GXFA529039

**Extended Oval Cylinder - 48mm**

GXFA529048

**Extended Oval Cylinder - 50mm**

GXFA529050

**Extended Oval Cylinder - 60mm**

GXFA529060

**Extended Oval Cylinder - 62mm**

GXFA529062

**Extended Oval Cylinder - 76mm**

GXFA529076

**Extended Oval Cylinder - 78mm**

GXFA529078

**Extended Oval Cylinder - 84mm**

GXFA529084

**Extended Oval Cylinder - 86mm**

GXFA529086

SCP, CP, PBU

## Euro Din & Oval Cylinders

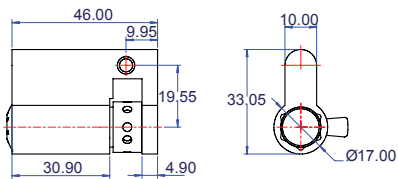

**Euro Profile Single Cylinder**

GXFA5211

SCP, CP, PBU

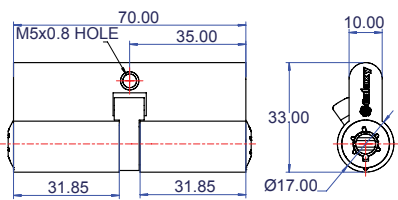

**Euro Profile Double - Fixed Cam**

GXFA5212

SCP, CP, PBU

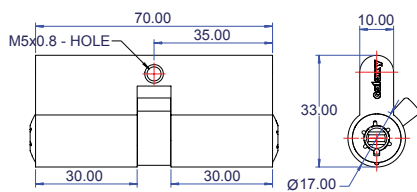

**Floating Cam version**

GXFA5212F

SCP, CP, PBU

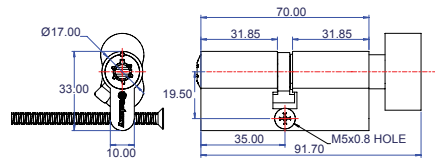

**Thumbturn Euro Profile - Fixed Cam**

GXFA5213

SCP, CP, PBU

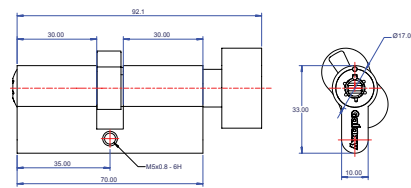

**Floating Cam version**

GXFA5213F

SCP, CP, PBU

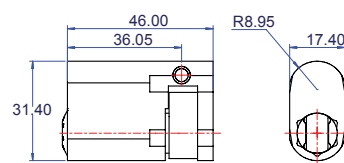

**Union Single (Oval)**

GXFA5231

CP, PBU

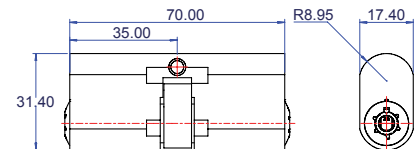

**Union Double (Oval)**

GXFA5232

CP, PBU

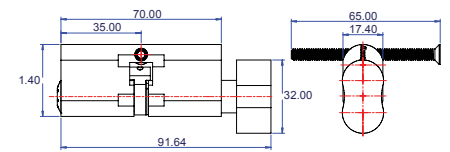

**Thumbturn Union (Oval)**

GXFA5233

CP, PBU

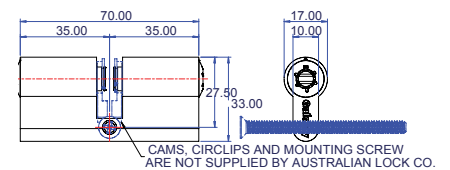

**Gainsborough TriLock**

GXFA5215

SCP, CP, PBU

## Padlocks

### Product

The Galaxy hardened steel padlock offers multiple features, not least of which is a competitive price that should see it quickly established as a market leader.

Features include:

- A protective polyurethane cushion which offers protection from other surfaces contacting the padlock.

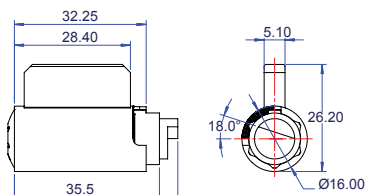

#### Master Pro Cylinder

GXFA6220

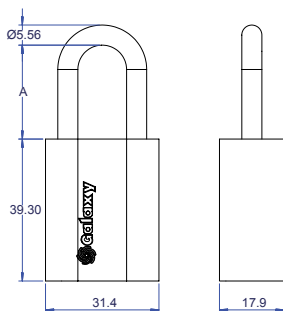

#### Small Brass Padlock

13mm Shackle - GXFA6232  
25mm Shackle - GXFA6232  
38mm Shackle - GXFA6232  
Less Shackle - GXFA6232LS

S, SA, SAA

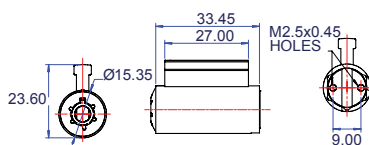

#### Padlock Cylinder 234B45 Lockwood

GXFA6236

- A Molybdenum shackle which is a super tough alloy steel for added protection.
- The BiLock padlock comes complete with cylinder or without cylinder.
- Marine grade - C6
- Hardened steel body.

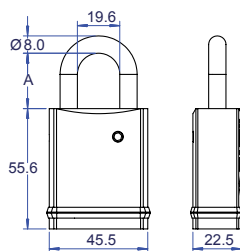

A = DIFFERENT SHACKLE  
LENGTHS ARE AVAILABLE  
25 - 50 & 75mm

#### 44mm Body Padlock

25mm Molybdenum Shackle - GXFA6244 - **S**  
50mm Molybdenum Shackle - GXFA6244 - **SA**  
75mm Molybdenum Shackle - GXFA6244 - **SAA**

25mm Stainless Steel Shackle - GXFA6244 - **SS**  
50mm Stainless Steel Shackle - GXFA6244 - **SSA**  
75mm Stainless Steel Shackle - GXFA6244 - **SSAA**

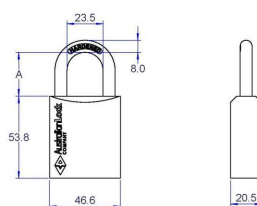

#### 46.6mm Body Padlocks

Key & Non Key retained. Offers snapp shut function. Solid brass, utilises 9224 cylinder. Shackle available in Hardened or Stainless Steel. Supplied with Tailbar Cam. Uses 1/16" Allen Key.

25mm Shackle - GXFA6240 - **S**  
50mm Shackle - GXFA6240 - **SA**  
75mm Shackle - GXFA6240 - **SAA**  
100mm Shackle - GXFA6240 - **XS**

25mm Stainless Steel Shackle - GXFA6240 - **SS**  
50mm Stainless Steel Shackle - GXFA6240 - **SSA**  
75mm Stainless Steel Shackle - GXFA6240 - **SSAA**  
100mm Stainless Steel Shackle - GXFA6240 - **SX**

### Typical Uses

Perimeter Gates  
Vehicles  
Vending Machines  
Industrial Safe Keeping  
Higher Security  
Areas/Buildings

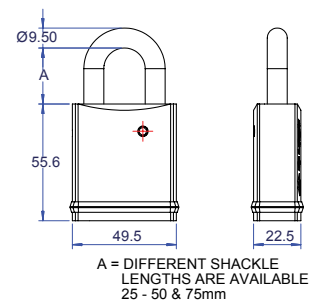

A = DIFFERENT SHACKLE  
LENGTHS ARE AVAILABLE  
25 - 50 & 75mm

#### 50mm Body Padlocks

25mm Molybdenum Shackle - GXFA6250 - **S**  
50mm Molybdenum Shackle - GXFA6250 - **SA**  
75mm Molybdenum Shackle - GXFA6250 - **SAA**

25mm Stainless Steel Shackle - GXFA6250 - **SS**  
50mm Stainless Steel Shackle - GXFA6250 - **SSA**  
75mm Stainless Steel Shackle - GXFA6250 - **SSAA**

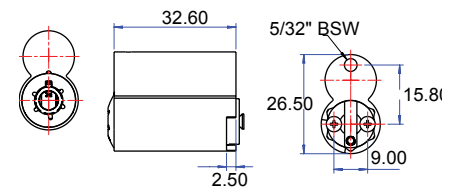

#### Abus Padlock Cylinder

GXFA6283

SCP, NB

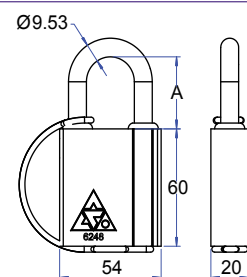

Shackle height (dimension 'A') is  
available in 37.85, 58 & 88mm

#### Weather and Dust Proof Padlock

GXFA6248

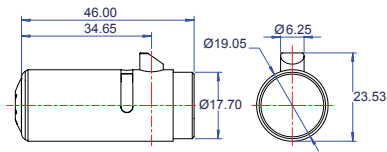

**"T" Handle Vending Lock Latching**

GXFA7210

CP, PBU

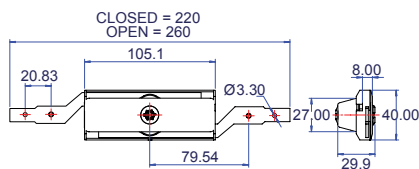

**Garage Door Lock**

GXFA7225

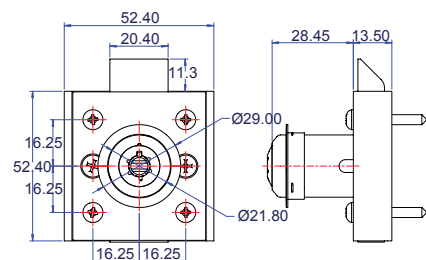

**Aluminium Cupboard/Drawer Lock Standard - Latching**

GXFA7252

CP, PBU

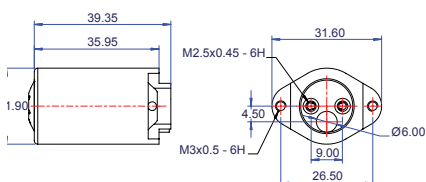

**Abloy Cupboard Lock**

GXFA7255 - CP

CP

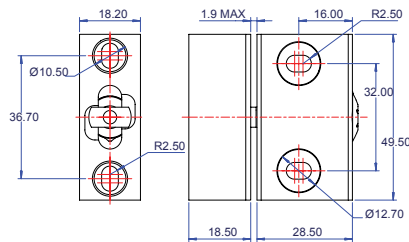

**Fridge Lock**

GXFA7265

CP

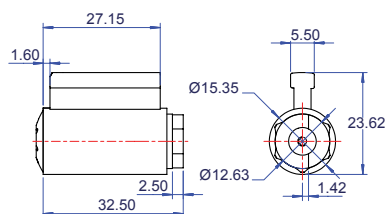

**Lockwood 8474 Garage Door Lock Cylinder**

GXFA7274

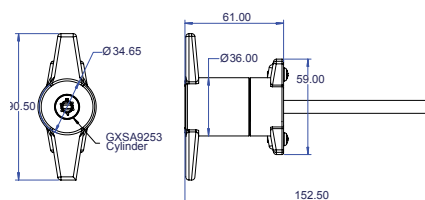

**Tee Handle**

GXFA7278

(Suits Lockwood 8474 Garage Door Lock)

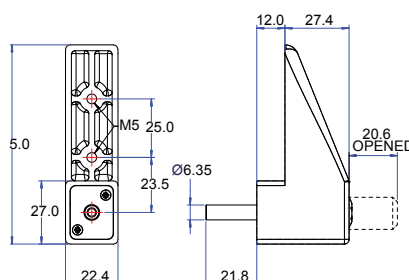

**Showcase Lock**

GXFA7287

SCP, CP, BLK



**Thru-Glass Pushlock**

GXFA7288

CP, PBU

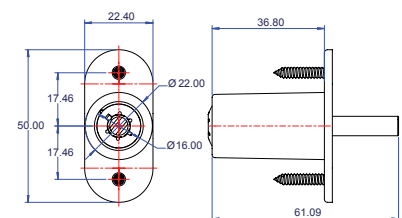
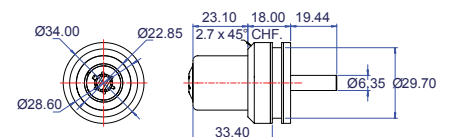

**Pushlock**

GXFA7289 - CP

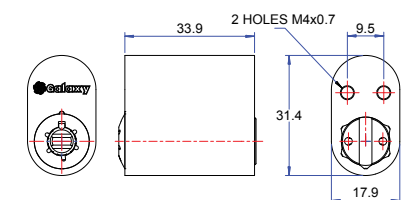

**Orb Cupboard Lock Cylinder**

GXFA7294

SCP, PBU

## Switchlock Cylinders

### Typical Uses

Gaming Equipment

Alarm Systems

Automatic Doors

Boom Gates

Elevators

Electric Vehicles

Flood Lighting

Security Lighting

Computer Equipment

Safety Switches

Escalators

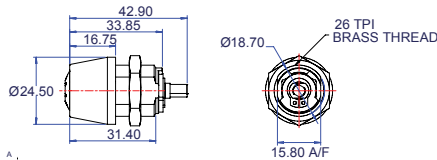

#### Modular Switchlock - 16 Code - No Switch

90 Deg Key W/D in Off Position - GXFA82059

180 Deg Key W/D in Centre Position - GXFA82051

90 Deg key W/D in Off Position - key removal 2 position - GXFA82059D

CP

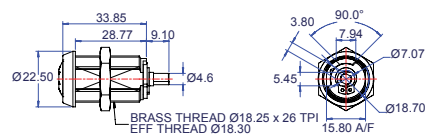

#### Modular Switchlock - 16 Code - No Switch

90 Deg Key W/D in Off Position - GXFA82099

180 Deg Key W/D in Centre Position - GXFA82091

90 Deg Key W/D in Centre Position - key removal 2 position - GXFA82099D

CP

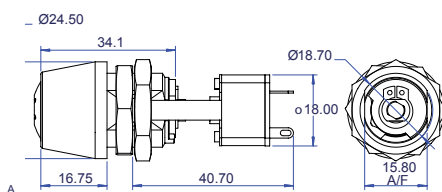

#### Modular Key Switchlock

On/Off 90 Deg Rotation - GXFA82259

On/Off 90 Deg Rotation - key removal 2 position - GXFA82259D

CP

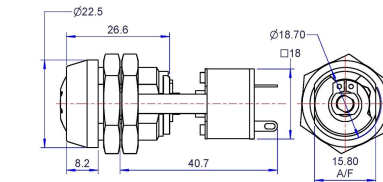

#### Modular Key Switchlock

On/Off 90 Deg Rotation - GXFA82269

On/Off 90 Deg Rotation - key removal 2 position - GXFA82269D

CP

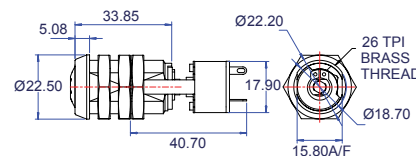

#### Modular Switchlock - 16 Code - No Switch

On/Off 90 Deg Rotation - GXFA82299

On/Off 90 Deg Rotation - key removal 2 position - GXFA82299D

CP

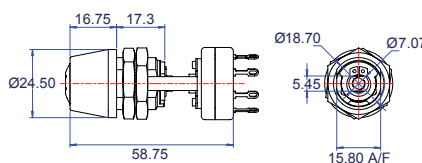

#### Modular Key Switchlock

On/Off/On 1 Pole 180 Degrees Rotation - GXFA82351

CP

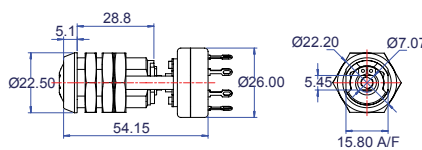

#### Modular Key Switchlock

On/Off/On 1 Pole 180 Degrees Rotation - GXFA82391

CP

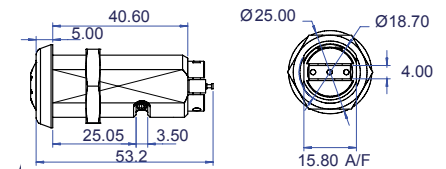

#### Integrated Key Switchlock

On/Off 1 Position Key Withdrawal - GXFA8240

CP

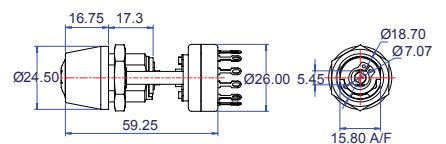

#### Modular Key Switchlock

On/Off/On 2 Pole 120 Degrees Rotation - GXFA82552

CP

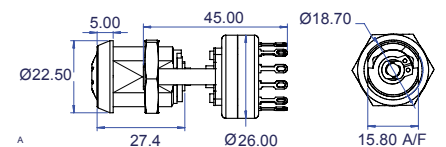

#### Modular Key Switchlock

On/Off/On 2 Pole 120 Degrees Rotation - GXFA82562

CP

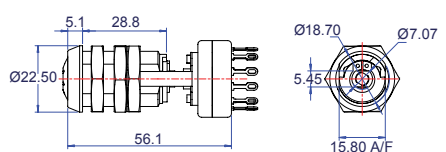

#### Modular Key Switchlock

On/Off/On 2 Pole 120 Degrees Rotation - GXFA82592

CP

## Key In Knob Cylinders

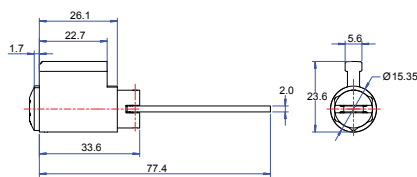

**Lockwood Macquarie  
9000 Outer**

GXFA9216

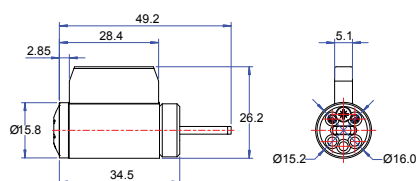

**Boyd A Series - Plymouth & Novo & Schlage  
Boyd A Series - Century & Tulip**

GXFA9220

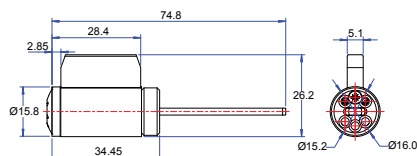

**Boyd D&H Series - (Long Tail) Schlage**

GXFA9220L

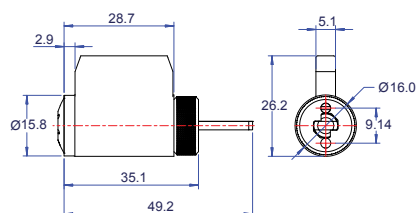

**Boyd  
B162P, 12Z, B462P, B862P & Schlage**

GXFA9222

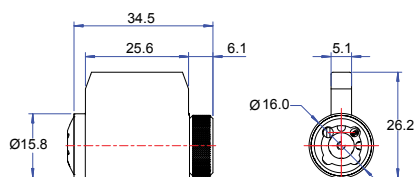

**Boyd A Series**

GXFA9224

*Suits:*

*Carbine Deadbolt, 4000 Series  
Carbine/Iico & 3000 Series (less tailbar)  
Gainsborough 4000 Series*

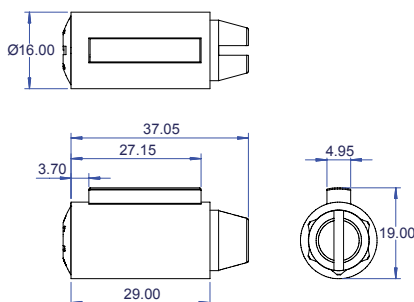

**EFCO "J" Series**

GXFA9230

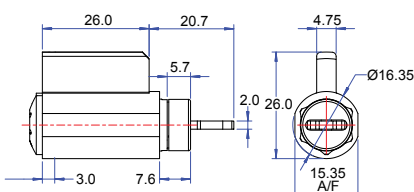

**Lane Apollo Entrance**

GXFA9231

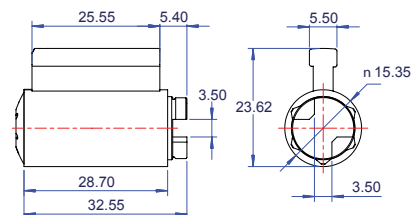

**Lockwood 530**

GXFA9253

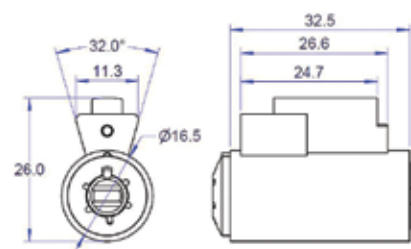

**Lockwood 500 V7**

GXFA9257

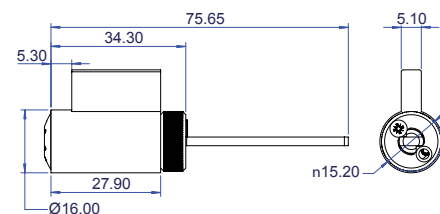

**Whitco W5000**

GXFA9262

*Suits: Forest, Mitchell, Napier, Oxley*

# Product Warranty

## Galaxy High Security Master Key System

Australian Lock Company guarantees its range of Galaxy High Security Cylinders against defects in workmanship & materials. Should the product be found to be defective within its normal working life, Australian Lock Company will repair or replace the product with the same or equivalent product free of charge upon receipt of proof of purchase.

Australian Lock Company provides a lifetime guarantee for its range of Galaxy keys.

Under this product warranty Australian Lock Company assumes no responsibility for the following:

1. Failure to adhere to fitting instructions or faulty installation.
2. Product wear & tear due to improper maintenance.
3. Product failure caused by the use of non Galaxy parts.
4. Unauthorised modifications or repairs made to the product.
5. Use of unauthorised replacement parts.
6. Any costs incurred due to –
  - i) Removal & or replacement of the Galaxy product.
  - ii) Freight & / or travelling time.
  - iii) Any modifications or repairs to the Galaxy product unless authorised by Australian Lock Company.
7. Personal injury, property damage or economic loss however caused.
8. Damage caused by corrosion when the Galaxy product is installed in a corrosive environment.

Nothing in this Australian Lock Company product warranty excludes, restricts or modifies in any condition, warranty, right or liability implied or protected by law where to do so would render the guarantee or any part of it void.



Supplier Details:  
Safeguard Locksmiths  
[www.safeguardlocksmiths.com.au](http://www.safeguardlocksmiths.com.au)  
1300 723 796



