

Twin® Keying Platform



Description

The Lockwood Twin® system ensures peace of mind with effective key control by employing stringent measures for the supply of key blanks patented features. Design Registration of the profiles prevents unauthorised duplication.

Features and Specifications

- Patent protected
- Dual pinning mechanism
- Pick-resistant design
- Drill protection
- Powerful high security deterrent to unauthorised entry
- Design Registration of all key profiles
- Master Keying for security and convenience
- Retrofits into most existing locks

Control of Keyways

The Lockwood Twin keyway is the combination of the key's profile and its side code.

Lockwood Twin Overview

Each Lockwood Twin Key has a unique security feature, an extra set of bitting along the side of the blade, the side code, in addition to the usual top. The

side code acts on side pins to line up with a side bar in the cylinder. Each key (or key set) also has a unique pattern of side grooves on the blade, forming the profile.

A key with the wrong Twin profile cannot even be inserted. A key with the wrong side code cannot release the side bar. For a key to open a lock, it must have the correct profile, side code and top code.

Side Code + Profile = Twin Keyway

The unique combination of side code and key profile is the keyway. Supply of keys by Lockwood or one of its Lockwood Twin Dealers is under customer signature control.

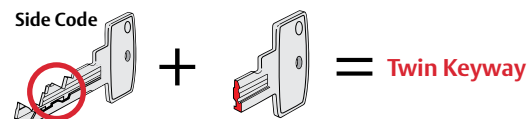

Identification of Keys

Individual keys within a Master Key System can be easily recognised through the use of colour coded inserts. There are a total of twelve colours to choose from.

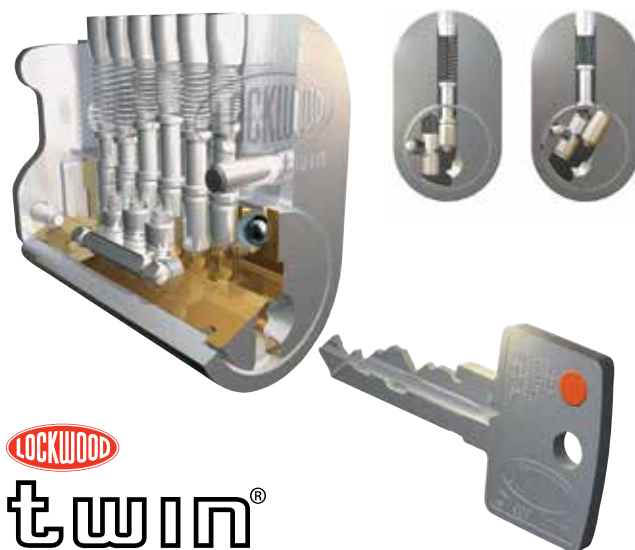

LOCKWOOD
twin®



Authorised Supplier

1300 723 796

www.safeguardlocksmiths.com.au